

! Attention: Ensure firearm is completely unloaded before attempting any modification. Unload, check inside the chamber, and remove any ammunition from the area.

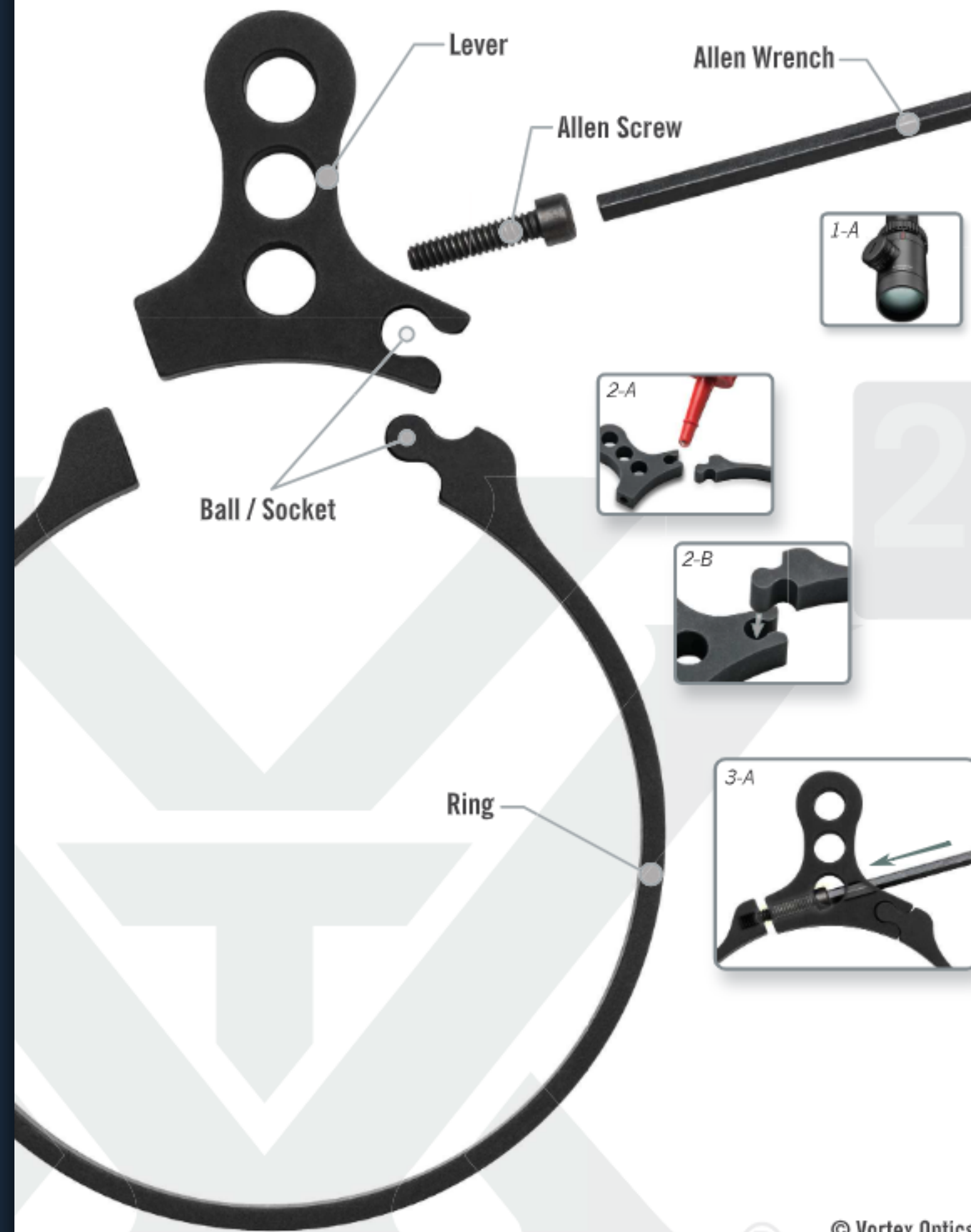

1 PRE-INSTALLATION

- Secure firearm or riflescope in a clamping device.
- Find the center of travel on your magnification adjustment ring and place a small mark at the center point as a reference when positioning.
- Riflescopes with an Illumination knob (1-A): Guide the ring over the eyepiece, gently spreading the ring around the illumination knob. Slide the ring past the magnification ring onto the riflescope tube.

2 BALL / SOCKET ASSEMBLY

- Apply one drop of lubricant to the ball of the ring. (2-A)
- Slide the ball into the socket of the lever. (2-B) GENTLY 'work' the lever onto the lubricated joint until connection is flush.

Note: Because of precise tolerances and variances in the thickness of the anodized coating, the connection may be exceptionally tight.

3 INSTALLATION

- Slide the assembled Switchview onto the magnification ring and align the lever with your previously marked center reference point.
- Insert the Allen Screw through the unthreaded hole in the lever and into the ring (3-A). Tighten to 5-7 inch-pounds with the Allen wrench.

Caution: Do not over-tighten. Over-tightening may cause damage to the Switchview and/or riflescope.

4 TESTING

- Test to ensure the Switchview lever is in the best position for you.
- To adjust, simply loosen the screw and reposition the lever to a more comfortable position. Then, retighten the screw and test new position.